



Quick Start Guide
ad infinitum
Sleek | Smart | Secure

ANYWHERE
EVERYWHERE



Introduction

Thank you for choosing ion4xi Wireless Access Point with 2x2:2 Multi-User MIMO and 802.11ax compliance.

Packaging Content



ion4xi
Access Point
(Qty:1)



DC Power Adaptor
(Varies by Region)
(Qty:1)



Mounting
Bracket
(Qty:1)



M4 X 30mm CSK screw
(Qty:4)



Quick Start
Guide
(Qty:1)



Plastic Wall
Anchors
(Qty:4)

ion4xi Specifications

Peak Throughput (aggregate)	Up to 1.78 Gbps
Wi-Fi Standard Support	802.11 a/b/g/n/ac/ac Wave 2/ax
Ethernet support/ Ports/Interface	1 X 10/100/1000BASE-T Ethernet 1 X 2500 Base X Optical Ethernet SFP DC Power jack
MU-MIMO	2x2:2
Mesh Support	Self-creating, Self-healing EasyMesh
Maximum number of SSID (per radio)	16
Maximum User Support	1024
Power Supply	IEEE 802.3at PoE/PoE+ or + 12V DC Power Adaptor
Power Consumption (Max)	20 W
Max Transmit Power	2.4 GHz- up to 30 dBm and 5 GHz- up to 30 dBm (will depend on country specific guidelines)
Antenna Type	Integrated Omni-directional antennas
Antenna Gain	4 dBi for both 2.4 GHz and 5 GHz
Management	Standalone (via GUI) or through on-premise based solution or cloud-based
Enclosure Dimensions	175 X 174 X 45 mm
Weight	0.60 kg
Operating Temperature	0°C to 55°C
Humidity	N/A
Certifications	FCC Class B, CE, Passpoint 2.0, EasyMesh, UL 2043 Plenum

Step 3: Check the LED status



LED Color	Status
Power LED Green	Green color notify the user that the device is powered ON
Status LED Red	Red color notify the user that the device is powered ON and radio is OFF
Status LED Green	Green color notify the user that the 2.4 GHz radio is active and blinks while data is being transmitted on 2.4 GHz radio
Status LED Blue	Blue color notify the user that the 5 GHz radio is active and blinks while data is being transmitted on 5 GHz radio
Status LED Cyan	Cyan color notify the user that both 2.4 GHz & 5 GHz radio are active and blinks while data is being transmitted on both radios

Safety Precautions

Observe the following safety precautions to avoid damage to the ion4xi Access Point:

! Do not subject the device to high temperatures

! Keep away from high voltage cables

! Disconnect the device before cleaning it

! Do not wipe the device with a damp cloth

! Do not open the enclosure of the Access Point

! Fasten the device tightly with the mount

Product Overview

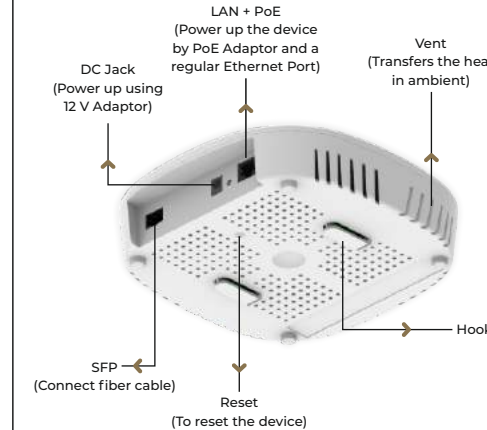

Mounting of ion4xi Access Point

1 Place the Mounting Bracket which came with the package on a wall or ceiling and mark holes with a marker where you will insert the screws. Drill holes in the marked points and insert the plastic wall anchors.

2. Use the supplied screws and attach the mounting bracket to the wall.

Note: Make sure that the mounting bracket is tightly installed before mounting the Access Point on the wall or ceiling.

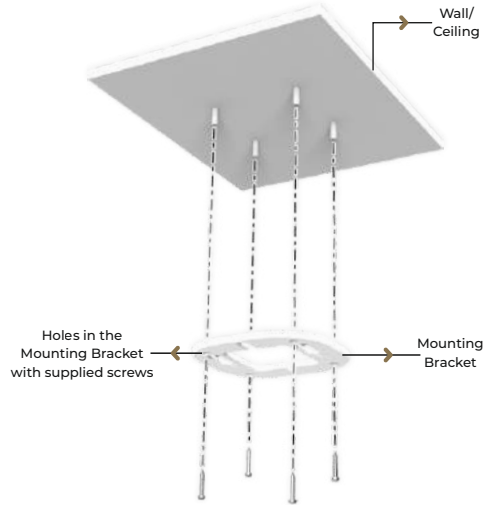

3. Align the mounting slots of Access Point with the hooks of the mounting bracket

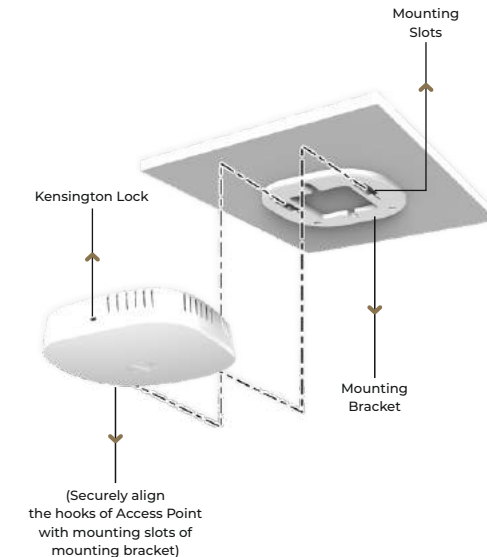

Unmounting of ion4xi Access Point

1. Slide the hooks of the Access Point out from the mounting slots of mounting bracket.

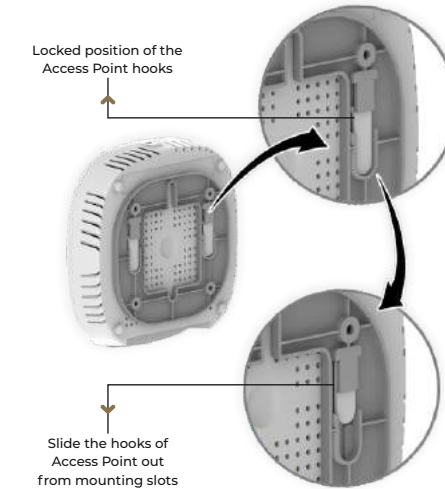

WARNING: Insecure mounting might damage the device or cause injury. IO is not responsible for damages incurred by insecure wall or ceiling mounting.

Getting the ion4xi Online

Step 1: Power up

The Access Point can be powered up using PoE Adaptor or DC Adaptor (12V) as shown below:

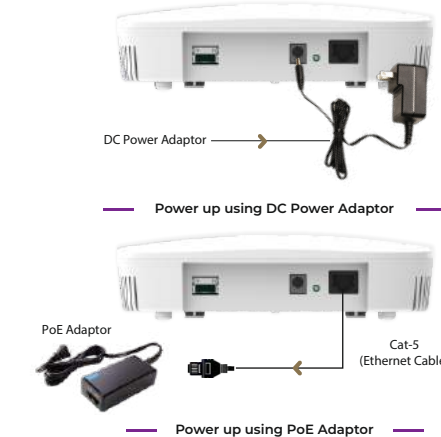

Note: The Reset button serves two functions:

Restart: Press and release the Reset button quickly.
Restore to Factory Default Settings: Press and hold the Reset button for more than five seconds.

Step 2: Connect to the network

Follow the steps mentioned below and connect the Access Point to a network through GUI:

1. Connect an Ethernet cable to the computer.
2. Connect the other end of the Ethernet cable to the LAN port on the ion4xi Access Point or use a PoE adaptor to do so.

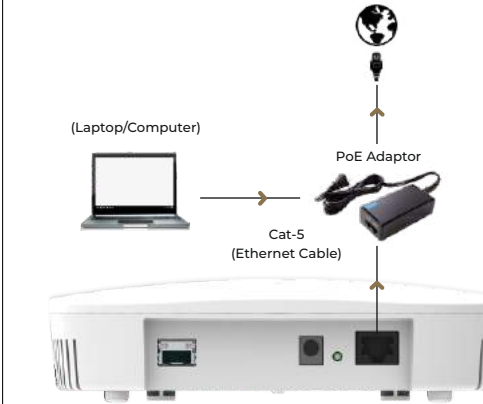

3. Open the web browser and enter the Access Point static IP address in the address bar:192.168.1.1

4. A login screen will appear.



5. Enter the default login credentials as provided with your ion4xi Access Point.

NOTE: Refer the respective user manual on our website www.ionetworks.in for detailed information on GUI features.



Contact us:
Email: iosupport@hfcl.com
Website: www.hfcl.com
www.io.hfcl.com
8, Commercial Complex, Masjid Moth
Greater Kailash-II, New Delhi-110048